

LW

低值合金電阻器 LOW OHM WIRE RESISTOR

DIMENSION

M form

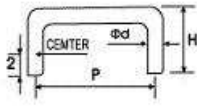

MK form

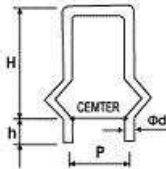

MB form

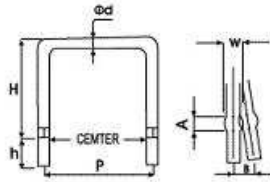

DERATING CURVE

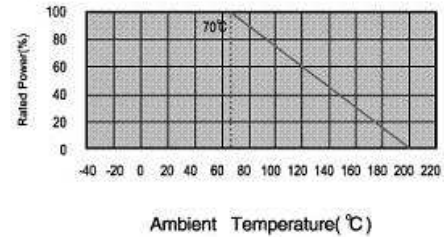

SPECIFICATIONS

| Diameter (mm) | Max. Current Rating(A) | Resistance Range(mΩ) | Resistance Tolerance | Rated Ambient Temp | Operating Temp Range |
|---------------|------------------------|----------------------|-----------------------------|--------------------|----------------------|
| 0.4 | 2.0 | 70 ~ 200 | K: ±10% J: ±5% G: ±2% | + 70°C | -40°C- +200°C |
| 0.5 | 2.5 | 50 ~ 150 | | | |
| 0.6 | 3.0 | 50 ~ 100 | | | |
| 0.7 | 4.0 | 20 ~ 70 | | | |
| 0.8 | 4.5 | 10 ~ 50 | | | |
| 0.9 | 5.0 | 10 ~ 40 | | | |
| 1.0 | 5.5 | 6 ~ 30 | | | |
| 1.1 | 6.0 | 6 ~ 20 | | | |
| 1.2 | 7.0 | 5 ~ 20 | | | |
| 1.3 | 7.5 | 5 ~ 20 | | | |
| 1.4 | 8.0 | 5 ~ 20 | | | |
| 1.5 | 9.0 | 3 ~ 20 | | | |
| 1.6 | 9.5 | 3 ~ 15 | | | |
| 1.8 | 11 | 3 ~ 10 | | | |
| 2.0 | 12 | 3 ~ 10 | | | |
| 2.3 | 14 | 3 ~ 5 | | | |
| 2.5 | 15 | 3 ~ 5 | | | |

NOTE: Special specification can be constructed on request.

ELECTRICAL PERFORMANCE

| Test Items | Specified Value |
|--------------------------------|----------------------------------|
| Temp coefficient of resistance | ±50, ±100, ±180PPW/°C |
| Short time overload | ±2% |
| Terminal strength | No evidence of mechanical damage |
| Resistance to soldering heat | ±1% |
| Solderability | Over 95% |
| Temperature cycling | ±1% |
| Moisture load life | ±5% |
| Load life at 70°C | ±5% |